

Solutions for today, Innovations for tomorrow.



WHOLE MUSCLE VACUUM STUFFER

VACUUM HAMLER-1320



VACUUM HAMLER-1320

This is the equipment to vacuumize and stuff whole muscle pieces in order to boost yield of it. By evacuating air easily entering between muscles in the vacuum chamber, mixing of air into products can be avoided. VH1320 is the matured device which can produce a longer length ham than the conventional NH720 and is boosting much more yield.

Vacuum

By stuffing after placing muscle pieces in vacuum chamber, mixing of air can be avoided.



Electrical Parts

Electrical parts are put together into one place. Further, by installing electrical parts on the upper part of the machine, it is minimizing the occurrence of electrical failures due to spattering of water.



Simple / Safe Cleaning and Sanitary

By fully opening the back side of vacuum chamber and removing pusher, cope and drag, the passage area for muscle pieces can be fully cleaned. It excels in safety and hygiene.



Product Coverage

By changing of nozzle, cope, drag, etc., it is possible to use for the products of not more than $\phi 95$.

LAYOUT

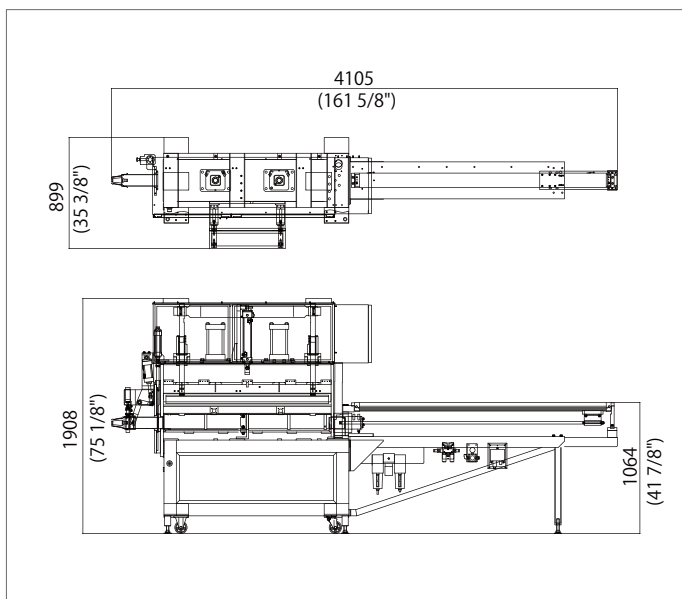

※ Layout dimension includes dimension of optional equipment

SPECIFICATION

	VACUUM HAMLER-1320
Height	1,908mm (75 1/8")
Nozzle Height	900mm (35 7/16")
Width	899mm (35 3/8") (Main Body only)
	1,677mm (66") (When vacuum pump is installed)
Length	4,105mm (161 5/8") (When the product length is 1 m)
Weight	About 1,300 kg (vacuum pump About 260 kg)
Supply air pressure	0.65MPa or more
Air consumption	160 L / min
Electric power	3 Phase 200 V
Pump motor (W)	7.5 kW

※ This specification and equipment are subject to change without notice.
 ※ The above production amount will be changed depending on products to be produced , production capacity of factory and other conditions.

HITEC CO.,LTD.

HEAD OFFICE & FACTORY
 2565-8, NAGATSUTA-CHO, MIDORI-KU, YOKOHAMA 226-0026, JAPAN
 PHONE +81-45-983-5000 FAX +81-45-983-0020
 E-mail: sales@hitec-jp.com
 Web : www.hitec-jp.com